

ENDOSCOPY AT GASTRO 2009

NOVEMBER 21-25, 2009
EXCEL LONDON
LONDON, UNITED KINGDOM



ESGE/OMED would like to thank the following companies for their support to the teaching activities of ESGE/OMED at GASTRO 2009 in London:



Special thanks for support of the Hands-on-Training Centre goes to:



WELCOME MESSAGE

3



European Society of Gastrointestinal Endoscopy (ESGE)
World Organisation of Digestive Endoscopy (OMED)

Contact:
ESGE & OMED
HG Editorial & Management Services
Mauerkircher Str. 29
81679 Munich, Germany

Tel. +49 (0)89/907 79 36-00
Fax +49 (0)89/907 79 36-20

secretariat@omed.org
www.omed.org

secretariat@esge.com
www.esge.com

**FOR MORE INFORMATION, VISIT US AT THE OMED AND ESGE BOOTHS
IN THE REGISTRATION AREA. (HALL N 1/2/3)**

ExCeL London
One Western Gateway
Royal Victoria Dock
E16 1XL London

Tel. +44 (0)20/7069 5000
Fax +44 (0)20/7069 4747

info@excel-london.co.uk
www.excel-london.co.uk



Lars Aabakken
ESGE GASTRO 2009 Coordinator



Jean-Francois Rey
OMED GASTRO 2009 Coordinator

Dear Colleagues

We are happy to welcome you to the ESGE/OMED activities at GASTRO 2009 in London!

World Organisation of Digestive Endoscopy (OMED) and European Society of Gastrointestinal Endoscopy (ESGE) are this year jointly responsible for the endoscopic content at GASTRO 2009 and we look forward to offering an interesting variety of features, including live demonstrations broadcast from three centres around the globe from Monday to Wednesday, diverse lectures throughout the week, plus interactive hands-on opportunities at the ESGE/OMED Learning Area.

This brochure will give you an overview of the endoscopy-related activities of GASTRO 2009 which we would like to encourage you to visit, and revisit. Most activities do not require pre-registration, so you are welcome to walk in at any time. As of Saturday, the ESGE/OMED Learning Area will be open to delegates.

We look forward to seeing you in London and hope that you will benefit from the offerings and the different kinds of interaction offered by OMED and ESGE, as well as our partners.

The first and foremost mission of OMED and ESGE is to promote good endoscopy and we welcome your help and interest in making it happen!

Sincerely,

Lars Aabakken

Jean-Francois Rey

TABLE OF CONTENTS

3	WELCOME MESSAGE
5	GENERAL INFORMATION
5	ESGE/OMED Learning Area
	<ul style="list-style-type: none"> • Hands-On-Training Centre • DVD Learning Centre • Lecture Theatre
6	Postgraduate Teaching Programme
6	ESGE/OMED Live Endoscopy from Centres of Excellence
6	Symposia
6	Working Party Reports
6	Common Interest Groups
7	DAY-BY-DAY OVERVIEW
8/9	<ul style="list-style-type: none"> • Saturday, November 21, 2009
10/11	<ul style="list-style-type: none"> • Sunday, November 22, 2009
12/13	<ul style="list-style-type: none"> • Monday, November 23, 2009
14/15	<ul style="list-style-type: none"> • Tuesday, November 24, 2009
16/17	<ul style="list-style-type: none"> • Wednesday, November 25, 2009
18/19	DVD Learning Centre Programme

GENERAL INFORMATION

5

ESGE/OMED LEARNING AREA

The doors of the ESGE/OMED Learning Area are open to all GASTRO 2009 delegates. The goal of the Learning Area activities is to serve endoscopic educational purposes and below is an overview of the main attractions. Several events are open on a walk-in basis, while others require registration.

- **Hands-On-Training on Biologic Models (in cooperation with ESGENA)**

With access to state of the art endoscopic equipment and accessories and with personal doctor and nurse tutoring, participants will have the opportunity to perform techniques that are demonstrated and discussed in the endoscopic section of the Postgraduate Teaching Programme.

Please check for availability at the information desk in the ESGE/OMED Learning Area.



- **DVD Learning Centre**

The DVD Learning Centre offers all delegates the opportunity to visit 18 stations where the latest teaching material may be viewed on video screens with headphone sound transmission.

Please see page 18/19 for detailed information about what is showing at each of the 18 stations.

- **Lecture Theatre**

Experts focus on topics of special interest before a small audience. Participants are invited to join in discussion following the presentation. In favour of a classroom atmosphere, the number of participants will be limited so interested delegates should ensure they arrive in good time.

GENERAL INFORMATION

6

POSTGRADUATE TEACHING PROGRAMME

On Saturday, 21 - Sunday, 22 November, the congress offers a full two-day postgraduate programme incorporating gastroenterology, hepatology, endoscopy, surgery, imaging and other diagnostic modalities.

ESGE/OMED LIVE ENDOSCOPY FROM CENTRES OF EXCELLENCE

From Monday, 23 - Wednesday, 25 November, live demonstrations will be broadcast from international centers in Hyderabad, London and Rome. Recognised for their outstanding reputation in delivering international education in the field of digestive endoscopy, these three centres are listed as official OMED Centres of Excellence.

OMED honorary lectures will be held between live transmissions. These talks are delivered at each World Congress to commemorate Drs. Rudolf Schindler, Francois Moutier and Sadataka Tasaka.

SYMPOSIA

Interdisciplinary symposia will cover new approaches to diagnosis and treatment, and place major emphasis on innovative technical advances in the non-invasive management of gastrointestinal and hepatic disorders and basic science, including State-of-the-Art and Named Lectures.

Lunch sessions will focus on the daily clinical practice of gastroenterology. Please note that these sessions are limited to a maximum of 30 participants. Registrations will be accepted on a "first-come, first-served" basis.

WORKING PARTY REPORTS

The goal of Working Party Reports is to present areas in need of a "new look" or where real guidance is required on classification, diagnostic criteria or therapeutic strategies.

COMMON INTEREST GROUPS

Common Interest Groups have the opportunity to meet at the congress outside the core programme.

7



DAY-BY-DAY OVERVIEW

SATURDAY, NOVEMBER 21, 2009

8

POSTGRADUATE TEACHING PROGRAMME

11.00 - 13.00 h
Hall S 1/2/3**Parallel Session 1/Part 1****Diagnostic Endoscopy**

- Oesophagogastrroduodenoscopy
- Detection of early upper GI Neoplasia
- Upper GI EUS
- Colonoscopy
- Detection of early lower GI neoplasia
- Small bowel enteroscopy

P. Sharma, USA
H. Tajiri, Japan
L. Aabakken, Norway
C. Williams, UK
S. Kudo, Japan
G. Haber, USA

11.00 - 13.00 h
Hall N 11/12**Parallel Session 4/Part 1****New techniques in colorectal surgery**

- NOTES: Is anyone taking note?

T. Roesch, Germany

14.00 - 16.00 h
Hall S 1/2/3**Parallel Session 1/Part 2****Therapeutic Endoscopy**

- Management of early oesophageal neoplasia
- Management of early gastric neoplasia
- Palliation of advanced oesophageal neoplasia
- Polypectomy
- Endoscopic submucosal dissection
- Palliation of advanced colorectal neoplasia

H. Inoue, Japan
H. Neuhaus, Germany
N. Marcon, Canada
B. Saunders, UK
N. Yahagi, Japan
T. Baron, USA

15.00 - 16.00 h
Hall N 7/8**Parallel Session 2/Part 4****Imaging and treatment of fibrotic liver and pancreatic disease**

- Interventional endoscopy

M. Giovannini, France

14.00 - 16.30 h
Hall N 9/10**Parallel Session 3/Part 2****GORD: Challenges and opportunities**

- New endoscopic imaging modalities: What do they add?
- Endoscopic treatment of GORD: A critical reappraisal

P. Sharma, USA

G. Costamagna, Italy

9

ESGE/OMED LEARNING AREA

Hall N 13

Hands-on-Training Centre**Hands-on-Training on biologic models****Techniques offered:**

- EMR
- Hemostasis
- Polypectomy/Mucosectomy
- ERCP beginners

Afternoon

13.30 - 15.00 h

Session 1

15.30 - 17.00 h

Session 2

EXCEL LONDON FLOORPLAN

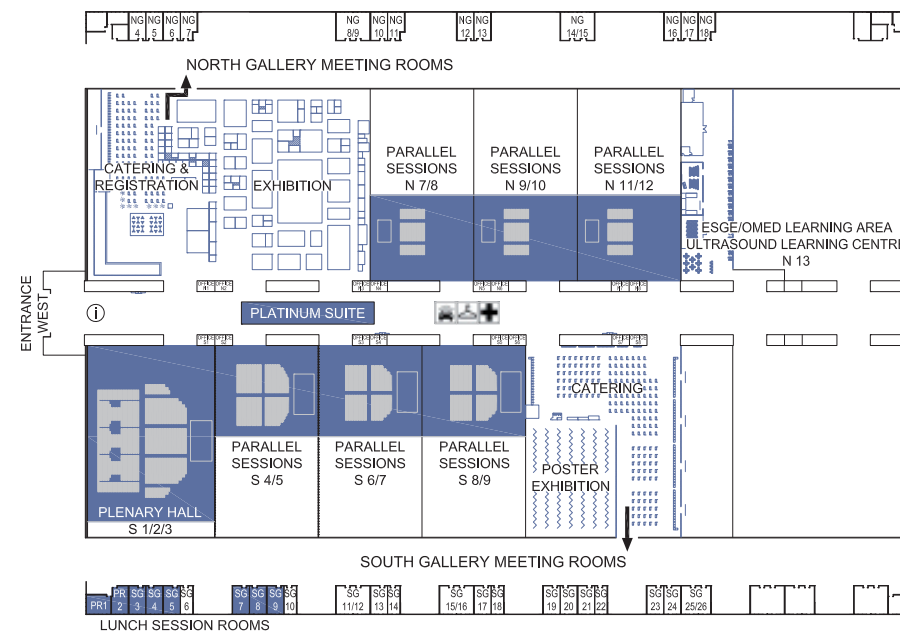

SUNDAY, NOVEMBER 22, 2009

10

POSTGRADUATE TEACHING PROGRAMME

08.30 - 09.30 h Hall S 1/2/3	Parallel Session 5/Part 1 ERCP Biliary 1	
	<ul style="list-style-type: none"> Cannulation of the papilla Endoscopic sphincterotomy and alternative techniques Cholangioscopy 	J. Deviere, Belgium C.S. Shim, S. Korea C. Navarrete, Chile
09.30 - 10.30 h Hall S 1/2/3	Parallel Session 5/Part 2 ERCP Biliary 2	
	<ul style="list-style-type: none"> Stone extraction Stenting Papillectomy 	J.J. Sung, Hong Kong R. Hawes, USA T. Ponchon, France
08.30 - 10.30 h Hall N 11/12	Parallel Session 8/Part 1 Oesophageal and gastric disorders	
	<ul style="list-style-type: none"> Optimum treatment of primary achalasia: Surgery or dilatation? 	G. Zaninotto, Italy
11.00 - 12.00 h Hall S 1/2/3	Parallel Session 5/Part 3 ERCP Pancreatic	
	<ul style="list-style-type: none"> Pancreatic sphincterotomy (Major/Minor) ESWL and stone extraction Pancreatic stenting 	G. Costamagna, Italy J. Deviere, Belgium D. Carr-Locke, USA
12.00 - 13.00 h Hall S 1/2/3	Parallel Session 5/Part 4 Therapeutic EUS	
	<ul style="list-style-type: none"> Drainage of pancreatic cysts and necrosectomy Drainage of abdominal abscesses Delivering therapy through EUS 	T. Roesch, Germany M. Giovannini, France W. Brugge, USA
14.00 - 16.00 h Hall S 1/2/3	Plenary Session 2 New advances in the management of Upper GI Bleeding	
	<ul style="list-style-type: none"> Life threatening haemorrhage from oesophageal and gastric varices Shifting sands: The management of bleeding peptic ulcers When should the radiologist and surgeon intervene...and what should they do? NSAID/aspirin/clopidogrel users: What should I do after the bleed? 	I. Mostafa, Egypt D. Jensen, USA O. van Delden, The Netherlands F. Chan, Hong Kong

11

ESGE/OMED LEARNING AREA

Hall N 13	Hands-on-Training Centre	
	Hands-on-Training on biologic models	
	Techniques offered:	
	<ul style="list-style-type: none"> EMR Hemostasis Polypectomy/Mucosectomy ERCP beginners Short wire systems 	
Morning		
09.00 - 10.30 h	Session 3	
11.00 - 12.30 h	Session 4	
Afternoon		
13.30 - 15.00 h	Session 5	
15.30 - 17.00 h	Session 6	
Hall N 13	ESGE Lecture Theatre	
11.30 - 12.00 h	<ul style="list-style-type: none"> SEMS: Utility in the upper GIT 	T. Baron, USA
13.00 - 13.30 h	<ul style="list-style-type: none"> Colonoscopy: Expert tips and tricks 	B. Saunders, UK
13.45 - 14.15 h	<ul style="list-style-type: none"> Endoscopic papillectomy 	T. Ponchon, France

COMMON INTEREST GROUPS

09.00 - 12.45 h SG 11/12	OMED and JGES (Japan Gastroenterological Endoscopy Society)	
	Narrow Band Imaging (NBI):	
	From classification to clinical practice	
		Chairs:
		A. Axon, UK (OMED President)
		M. Kaminishi, Japan (JGES President)

MONDAY, NOVEMBER 23, 2009

12

LIVE ENDOSCOPY SESSION

11.00 - 12.30 h
Hall S 1/2/3

Video Case Session

The video case marathon has for years proven to be among the most popular items of international gastroenterology meetings. Based on submitted material, a selection of the most spectacular, educational and memorable video cases are shown and commented by expert panel participants.

14.00 - 17.15 h
Hall S 1/2/3

Live Endoscopy via satellite from OMED Centre of Excellence Asian Institute of Gastroenterology, Hyderabad, India

Director:
N.D. Reddy, India

OMED Francois Moutier Lecture

Therapeutic endoscopy: From evidence-based medicine to craftsmanship

G. Costamagna, Italy

OMED Research Award

Presentation

N. Yahagi, Japan

ESGE/OMED LEARNING AREA

Hall N 13

10.45 - 11.15 h

11.30 - 12.00 h

12.15 - 12.45 h

13.00 - 13.30 h

13.45 - 14.15 h

14.30 - 15.00 h

ESGE Lecture Theatre

- Diagnostic EUS, EUS-FNA: Expert tips and tricks
- Variceal bleeding, treatment and prevention
- Balloon Enteroscopy
- SEMS: Biliopancreatic system
- ERCOP and EST: Expert tips and tricks
- Capsule endoscopy: Current role in small Bowel

W.R. Brugge, USA

I. Mostafa, Egypt

H. Yamamoto, Japan

G. Costamagna, Italy

H. Neuhaus, Germany

M. Pennazio, Italy

SYMPOSIA

11.00 - 12.30 h
Hall S 4/5**Place of surgery in IBD**

- Dysplasia: Colonoscopy or colectomy? R. Kiesslich, Germany/S. Itzkowitz, USA

11.00 - 12.30 h
Hall S 6/7**Rectal cancer treatment**

- Pre-treatment staging
- Endoluminal therapy
- Role of the specialized surgeon
- Current state of neoadjuvant therapy

G. Brown, UK

N. Yahagi, Japan

L. Pahlman, Sweden

R. Sauer, Germany

13

12.45 - 13.45 h
Room PR2**Lunch session**

- Endoscopic management of bariatric surgery complications J. Deviere, Belgium/T. Baron, USA

14.00 - 15.30 h
Hall S 8/9**Barrett's oesophagus: A global perspective**

- Is Barrett's oesophagus a worldwide problem? K. M. Fock, Singapore
- Working Party Report: Early recognition of Barrett's oesophagus related neoplasia: The BORN project P. Sharma, USA
- Can we prevent cancer, and if so, how? J. Bergman, The Netherlands
- New technologies and techniques: Do they work, and are they practical for all? J. Jankowski, UK
- Do they work, and are they practical for all? J. Bergman, The Netherlands

15.45 - 17.15 h
Hall S 8/9**Upper GI bleeding and NSAIDs:****Why do patients die, and how can we save them?**

- Preventing and treating aspirin/NSAID ulcers: How and in whom? F. Chan, Hong Kong
- Best endoscopic treatment for bleeding ulcers; what does the evidence say? M. Barthet, France
- Cardiovascular and other adverse effects of COX-2 selective and non-selective NSAIDs G.A. Fitzgerald, USA
- Why do patients die from Upper GI bleeds, and how can we improve outcome? R. Logan, UK

15.45 - 17.15 h
Platinum 3/4**Management of anorectal disorders: An update**

- Ileo-anal pouch: Surveillance and therapeutic trends T. Oresland, Norway

COMMON INTEREST GROUPS

17.15 - 19.15 h
SG 24**OMED****Safe sedation in gastrointestinal endoscopy**

Chairs:
S. Ladas, Greece

17.30 - 18.30 h
SG 25/26**ECCO/OMED****Consensus role of small bowel endoscopy in the management of patients with IBD**

Chairs:
S. Travis, UK

TUESDAY, NOVEMBER 24, 2009

14

LIVE ENDOSCOPY SESSION

08.30 - 12.30 h
Hall S 1/2/3

**Live Endoscopy via satellite from
OMED Centre of Excellence
Wolfson Unit for Endoscopy, London, UK**

Director:
B. Saunders, UK

OMED Sadataka Tasaka Lecture
Recent advances of electronic endoscope:
Image-enhanced endoscopy

H. Tajiri, Japan

ESGE/OMED LEARNING AREA

Hall N 13
10.30 - 11.00 h
11.30 - 12.00 h
12.15 - 12.45 h
13.30 - 14.00 h
14.15 - 14.45 h

ESGE Lecture Theatre

- Enhancing white light endoscopy in the upper GIT
- Management of non-variceal upper GI bleeding
- Endotherapy of chronic pancreatitis
- EMR or ablation in the oesophagus
- Therapeutic EUS: Expert tips and tricks

R. Bisschops, Belgium
J.J.Y. Sung, China
J. Deviere, Belgium
B. Rembacken, UK
M. Giovannini, France

SYMPOSIA

08.30 - 10.30 h
Hall S 8/9**NOTES: Is there a future?**

- The development and vision of NOTES
- Progress report Europe (EURONOTES)
- Progress report North America
- Progress report Asia
- Progress report Latin America
- A surgeon's perspective
- A gastroenterologist's perspective

N. Reddy, India
P. Fockens, The Netherlands
R. Hawes, USA
E. Ng, Hong Kong
C. Navarrete, Chile
A. Fingerhut, France
E. Quigley, Ireland

08.30 - 10.30 h
Platinum 3/4**Intrahepatic gallstones**

- Classification
- An Asian perspective
- Endotherapy
- The percutaneous approach
- Surgical resection

J. Belghiti, France
T. Mori, Japan
H. Neuhaus, Germany
C.S. Shim, S. Korea
F. Giuliani, Italy

08.30 - 10.30 h
Hall S 4/5**GORD treatment: Current problems and new solutions**

- WGO Brohée Lecture: Acid secretion in the developed world: Now too much of a good thing?
- Improving acid suppression: Is the best to come?
- Inhibitors of TLOSRs: Where are we today?

K. McColl, UK
R. Hunt, Canada
A. Smout, The Netherlands

15

- Endoscopic treatment: The beginning of the end or the end of the beginning?
- Laparoscopic anti-reflux surgery: Does LARS last?

J. Deviere, Belgium
D. Watson, Australia

11.00 - 12.30 h
Platinum 1**Autoimmune pancreatitis**

- Clinical and immunological characteristics of AIP in Asia
- How to diagnose autoimmune pancreatitis?
- Imaging characteristics
- Therapeutic options

M.H. Kim, S. Korea
L. Frulloni, Italy
W. Brugge, USA
C. Suresh, USA

12.45 - 13.45 h
Room PR2**Lunch sessions**

- Branch type IPMN:
When to observe, when to operate?
- ESD
- Resistant GORD:
Non-surgical management strategies

W. Brugge, USA/C. Bassi, Italy
H. Neuhaus, Germany/N. Yahagi, Japan
S. Riley, UK/J.P. Galmiche, France

14.00 - 15.30 h
Hall S 8/9**Treatment of pancreatic cancer**

- Molecular tools for early detection of pancreatic cancer
- Molecular tools for treatment stratification in pancreatic cancer
- Resection of pancreatic cancer: Is it all palliation?
- Endoscopic palliation in pancreatic cancer

M. Loehr, Sweden
M. Lutz, Germany
B. Gudjonsson, Iceland
G. Haber, USA

14.00 - 15.30 h
Hall S 1/2/3**Capsule endoscopy: From top to bottom**

- Oesophagus
- Small bowel
- Colon
- New perspectives

D. Cave, USA
M. Keuchel, Germany
A. Van Gossum, Belgium
R. Eliakim, Israel

15.45 - 17.15 h
Hall S 8/9**Pancreatic cystic lesions**

- Differentiating cystic lesions of the pancreas
- The role of EUS in differentiating pancreatic lesions
- Intraductal pancreatic mucinous neoplasms (IPMN)
- Surgical strategies for metastasized pancreatic tumours

M. Barthet, France
M. Giovannini, France
C. Bassi, Italy
H. Friess, Germany

15.45 - 17.25 h
Hall S 1/2/3**Endoscopic complications: When to call the surgeon**

- Retroperitoneal perforations after endoscopic sphincterotomy
- Necrotizing pancreatitis
- Upper GI perforations
- Colonic perforations
- The role of NOTES

C. Navarrete, Chile
R. Carter, UK
T. Roesch, Germany
A. Engel, The Netherlands
T. Kalloo, USA

WEDNESDAY, NOVEMBER 25, 2009

16

LIVE ENDOSCOPY SESSION

08.30 - 13.00 h
Hall S 1/2/3

**Live Endoscopy via satellite from
OMED Centre of Excellence
Policlinico Universitario "A. Gemelli",
Universita Cattolica del Sacro Cuore,
Rome, Italy**

Director:
G. Costamagna, Italy

OMED Rudolf Schindler Lecture

Endoscopy and the ugly duckling

J. Wayne, USA

Working Party Report

Endoscopy guidelines for credentialing

Chair:
D. Faigel, USA

ESGE/OMED LEARNING AREA

Hall N 13
10.45 - 11.15 h
11.30 - 12.00 h**ESGE Lecture Theatre**

- EMR or ESD? The European approach J. Haringsma, The Netherlands
- Polypectomy and EMR in the colon J. Wayne, USA

SYMPOSIA

08.30 - 10.30 h
Platinum 3/4**New frontiers in the management of
colorectal cancer**

- Imaging algorithms for detecting CRC recurrence M. Bellomi, Italy
- The role of laparoscopy and fast track surgery W. Bemelman, The Netherlands
- Evolution of surgery for liver metastases R. Adam, France
- Endoscopic stenting for palliation T. Baron, USA
- Targeted treatment and chemotherapy W. Schmiegell, Germany

08.30 - 10.30 h
Hall S 4/5**CRC screening strategies**

- Cascade guidelines for CRC screening in different healthcare systems N. Amrani, Marokko
- Quality control in colonoscopy and implications for screening programmes J. Regula, Poland
- The role CT colonography A. Laghi, Italy
- Molecular screening for colorectal cancer W. Grady, USA
- Working party report: Guidelines for evaluation of new screening tests for colorectal and gastric cancers G. Young, Australia

17

11.00 - 12.30 h
Platinum 3/4**CRC Surveillance and treatment of dysplasia
and early cancer**

- Surveillance for sporadic colorectal neoplasia J. Regula, Poland
- Best practice for neoplasia surveillance in IBD J. Rhodes, UK
- Endoscopic techniques for surveillance and treatment of dysplasia B. Saunders, UK

11.00 - 12.30 h
Hall N 9/10**Early oesophageal cancer and HGD:
Advances in diagnosis and treatment**

- Advances in endoscopic diagnosis: The end of blind quadrant biopsies in Barrett's oesophagus? K. Ragunath, UK
- Confocal microscopy: Should it replace biopsy? A. Meining, Germany
- Emerging endoscopic therapies for HGD and early cancer H. Inoue, Japan
- Minimally invasive surgery L. Bonavina, Italy

12.45 - 13.45 h
Room PR2
Room PR1**Lunch sessions**

- Balloon assisted endoscopy M. Delvaux, France/M. Keuchel, Germany
- Self-expanding metallic biliary stents: D. Carr-Locke, USA
- Covered or uncovered? J. Spicak, Czech Republic

14.00 - 15.30 h
Hall N 7/8**Palliation of malignant gastroduodenal obstruction**

- Metal stents for palliation D. Carr-Locke, USA
- Magnetic or pressure device anastomoses N. Chopita, Argentina
- NOTES techniques A. Fritscher-Ravens, UK
- Or maybe surgery? H. Bruch, Germany

DVD LEARNING CENTRE

18

The DVD Learning Centre offers all delegates the opportunity to visit 18 stations where the latest teaching material may be viewed on video screens with headphone sound transmission. Case studies from the ESGE DVD Encyclopaedia are complemented by select video submissions from OMED, ASGE and contributors from Japan. This offering is ideal for individual study and special interest.

ESGE ENCYCLOPEDIA

Station 1	ESGE Postgraduate Course, Vienna 2008: Live endoscopy demonstrations. S. Rejchrt, Czech Republic
Station 2	New trends in therapeutic ERCP: Benign diseases (Module 15) G. Costamagna, Italy
Station 3	Best of Gastroenterology and Endotherapy Week (G.E.E.W) J. Deviere/P. Eisendrath/O. Le Moine, Belgium
Station 4	Update on upper GI bleeding endoscopic management (Module 18) A. Nowak, Poland/J.R. Armengol-Miro, Spain/J-F. Rey, France
Station 5	Update on lower GI bleeding endoscopic management (Module 19) A. Van Gossum, Belgium/J.R. Armengol-Miro, Spain/J. Spicak, Czech Republic/ J-F. Rey, France
Station 6	Update on upper GI therapeutic endoscopy (Module 23) J-F. Rey, France/L. Aabakken, Norway/with the participation of A. Alhassani, France/ K. Kuznetsov, Russia
Station 7	Video capsule endoscopy and balloon enteroscopy for small bowel exploration: A global approach (OMED/ESGE) J-F. Rey, France/L. Aabakken, Norway/with the participation of A. Alhassani, France/ K. Kuznetsov, Russia
Station 8	Superficial colorectal neoplastic lesions (Module 25) R. Lambert, France/J-F. Rey, France/S. Tanaka, Japan/S. Rejchrt, Czech Republic/ A. Geagea, Lebanon
Station 9	Endoscopic aspects of the digestive mucosa with narrow band imaging technology (Module 26) J-F. Rey, France/H. Tajiri, Japan/S. Tanaka, Japan/F. Schreiber, Austria/ R. Lambert, France

19

OTHER CONTRIBUTIONS

Station 10	Trimodal endoscopic diagnosis and endoscopic submucosal dissection (ESD) for colorectal tumor Y. Saito/T. Sakamoto/T. Nakajima/T. Aoki/T. Matsuda, Japan
Station 11	Double balloon endoscopy H. Yamamoto, Japan
Station 12	Image enhanced endoscopy-i-scan M. Fujishiro, Japan
Station 13	EMRC for early gastric adenocarcinoma S. Nagao, Japan
Station 14	Endoscopic mucosal resection for early stage esophageal cancer T. Omori, Japan
Station 15	Unusual GI and biliary stenting C.S. Shim/H.S. Park/T.Y. Lee, S. Korea
Station 16	Therapeutic EUS (ASGE)
Station 17	Techniques of endoscopic therapy in pancreatic disorders (ASGE)
Station 18	Endoscopic management of variceal hemorrhage in cirrhosis (ASGE)